

JEFA TECH REPEATER XR - DC POWER POE ASSEMBLY

In this procedure, you will replace the AC Power POE Injector with a 12 Volt DC POE Injector (POE = Power Over Ethernet)
This allows you to power your JEFA Tech Repeater XR with DC Power instead of AC 120 V Power

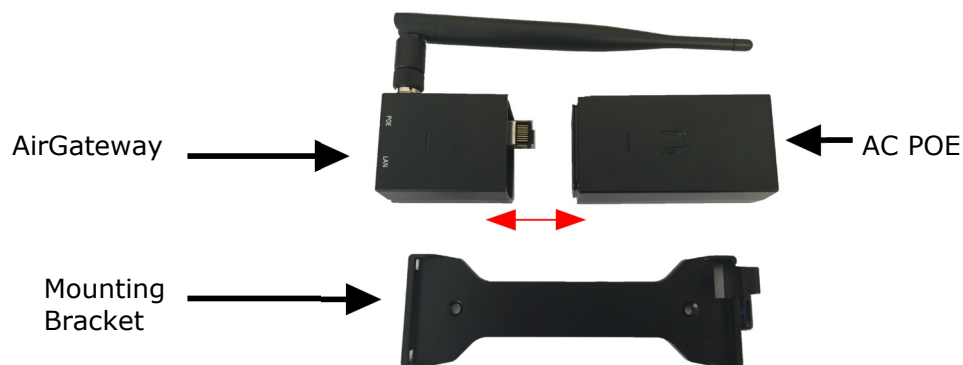

STEP 1: Observe AirGateway and AC POE Injector assembly as received with the JEFA Tech Repeater XR



STEP 2: Remove mounting bracket and snap apart AirGateway from AC POE

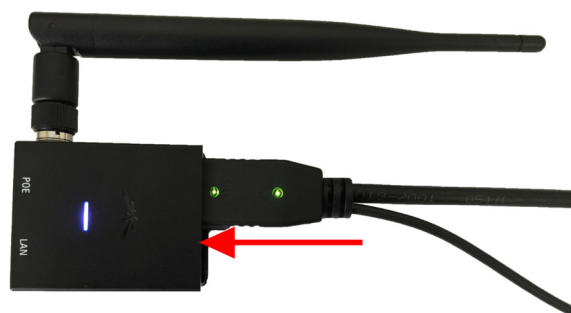

STEP 3: Connect DC POE Injector to Male Ethernet Jack on AirGateway - this is the plug on the opposite side from the Ethernet jacks marked POE and LAN

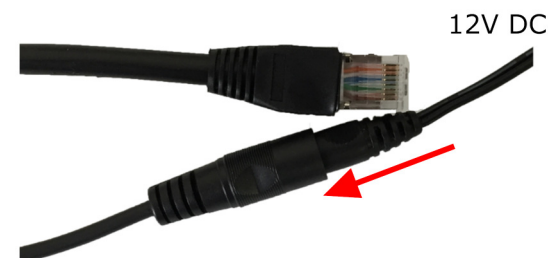

STEP 4: Connect a 12V DC Power Source to the DC POE Injector. You will see two green lights on the DC POE and a light on the AirGateway

- After this conversion, the AC POE and mounting bracket is no longer used. Keep them to switch back to AC 120 V operation.
- When using the bare lead option, the lead with the white stripe is +12V

JefaTech
Wireless Technology Solutions